

Rotax 912i (Series) Engines

Checking of the Correct Positioning of Sealing Plug in Ignition Housing

The UK CAA have recently issued an Emergency Mandatory Permit Directive (EMPD 2017-005-E) requiring checks to all Rotax 912i (Series) engines. This EMPD mandates a Rotax Alert Service Bulletin (ASB-912-i-007) which asks all owners of Rotax 912i (series) engines to check the correct fitment of an oil sealing plug in the ignition housing.

The problem appears to be that the oil sealing plug was not firmly seated during the assembly of the ignition housing and that this may lead to oil leaks or, in the worst case, the plug falling out which could lead to a total loss of oil and engine seizure.

A copy of EMPD 2017-005-E can be found [HERE](#).

A copy of the Rotax Service Bulletin, ASB-912-i-007 can be found [HERE](#).

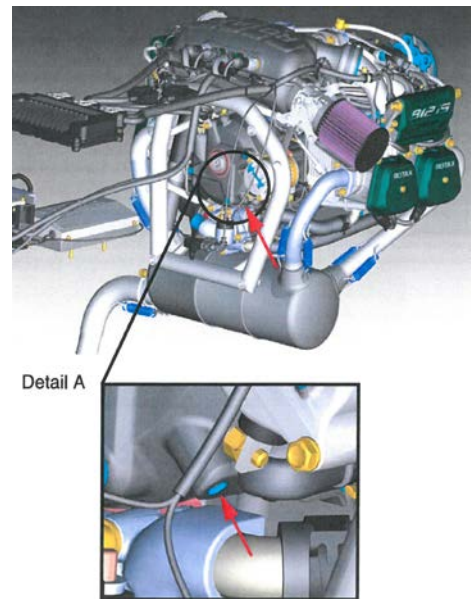

Fig. 1 This General Arrangement drawing shows the position of the ignition housing, Detail A shows the position of the sealing plug

Ball Insertion Tool

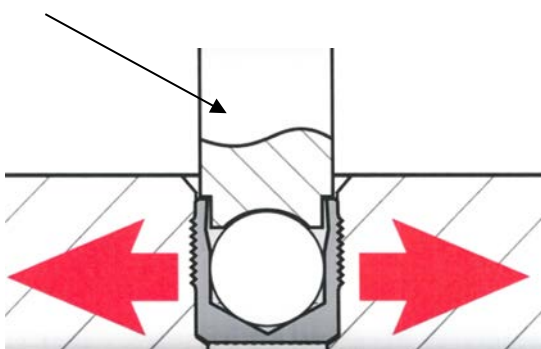

Fig. 2 This sketch shows the correct position of the expansion ball in the oil sealing plug. Note that the ball expands the sealing plug firmly into the casting of the ignition housing.

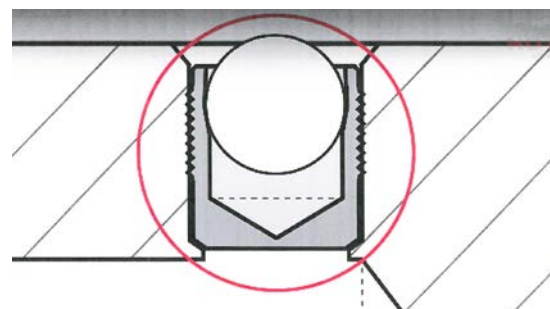

Fig. 3 This sketch shows a ball that hasn't been driven firmly home into the oil sealing plug; this situation can be dangerous as it could leave the sealing plug loose in the casting.